

- GENERAL NOTES:**
1. ALL DIMENSIONS ARE UNLESS OTHERWISE SPECIFIED.
 2. ALL DIMENSIONS ARE IN MM.
 3. ALL EXTERNAL WALLS SHALL BE 200 MM THICK UNLESS OTHERWISE SPECIFIED.
 4. ALL EXTERNAL WALLS SHALL BE FINISHED WITH 200 MM THICK BRICK WORK.
 5. ALL EXTERNAL WALLS SHALL BE FINISHED WITH 200 MM THICK BRICK WORK.
 6. ALL EXTERNAL WALLS SHALL BE FINISHED WITH 200 MM THICK BRICK WORK.
 7. CONTRACTOR TO CHECK & VERIFY ALL DIMENSIONS BEFORE EXECUTION OF THE WORK.
 8. ALL EXTERNAL WALLS SHALL BE FINISHED WITH 200 MM THICK BRICK WORK.
 9. ALL EXTERNAL WALLS SHALL BE FINISHED WITH 200 MM THICK BRICK WORK.
 10. THERE SHALL BE PROPER SQUARE FOR HANDICAPPED TOILET, HANDICAPPED ACCESSED RAMP, FIRE ESCAPE ETC.

DOOR & WINDOW SCHEDULE:

SCHEDULE OF DOORS & WINDOWS:			
WINDOWS			
MARK	WIDTH	HEIGHT	REMARKS
W1	800	1000	
W2	800	1400	
W3	1000	1000	
W4	800	800	
W5	800	1000	
DOORS			
DOOR	WIDTH	HEIGHT	REMARKS
D01	800	2100	
D02	1000	2100	
D03	1000	2100	
D04	1000	2100	
D05	800	2100	
D06	800	2100	
D07	2100	2400	
D08	2400	2400	
ROLLING SHUTTER			
RS1	WIDTH	HEIGHT	REMARKS
RS1	2400	2400	
RS2	2400	2400	
RS3	1500	3000	
RS4	1500	3000	

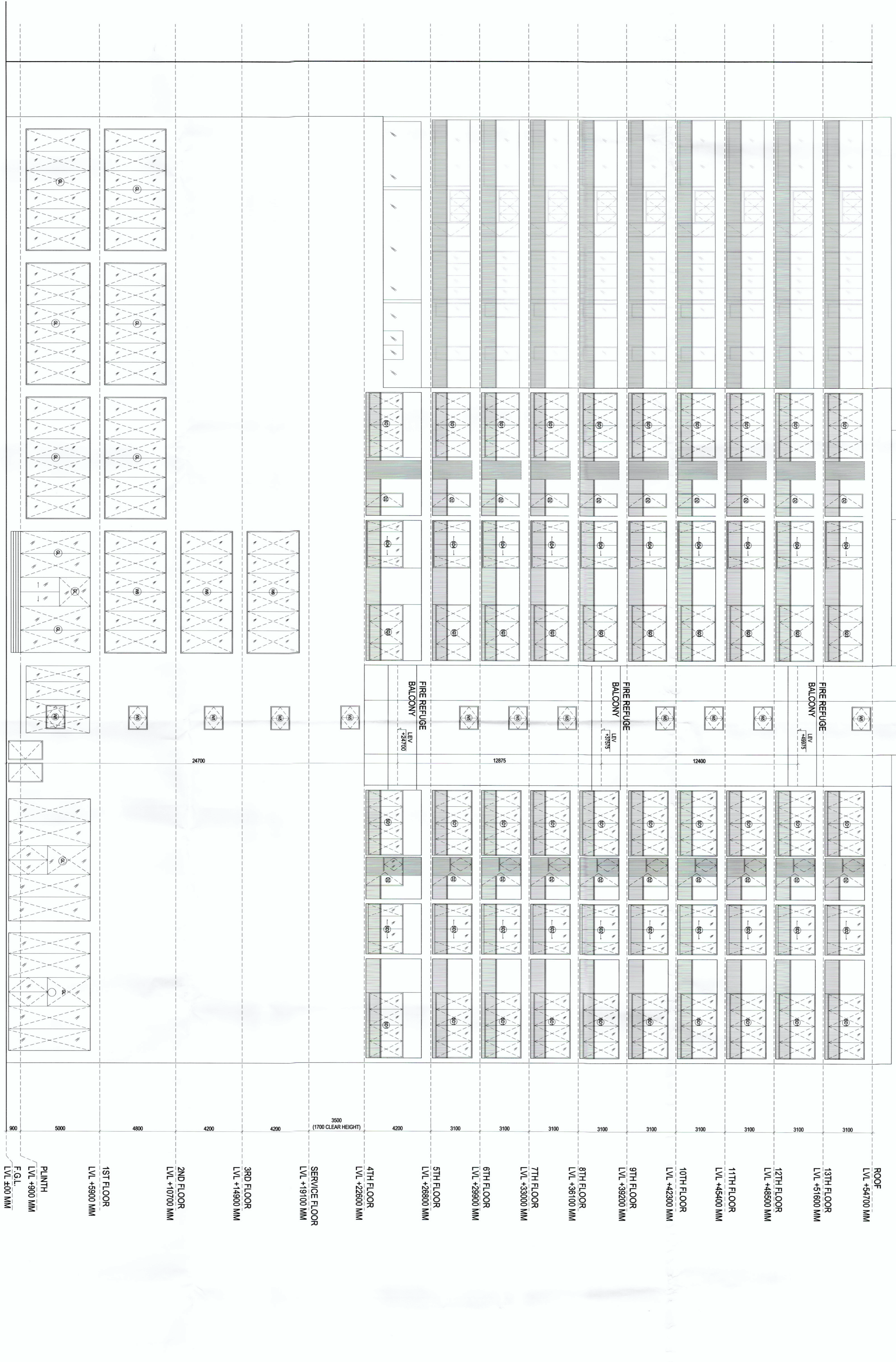

FRONT (WEST) SIDE ELEVATION
SCALE: 1:100

- SPECIAL NOTE:**
1. BASEMENT IS ARCHITECTURALLY VENTILATED.
 2. PRESSURIZED AS PER FIRE NORMS TO BE PROVIDED.
 3. ALL FIRE TOWER LIGHTS TO BE PROVIDED.
 4. ALL LEFT DOOR WILL BE FIRE RESISTANT.
 5. ALL INTERNAL STAIRWELL & LIFT SHAFTS TO BE FINISHED WITH 150 MM THICK CONCRETE WALLS.
 6. ALL HORIZONTAL STONE WALLS TO BE FINISHED WITH 150 MM THICK CONCRETE WALLS.

COPYRIGHT - THIS DRAWING IS THE PROPERTY AND COPYRIGHT OF SALIENT. IT SHALL NOT BE COPIED OR REPRODUCED IN ANY MANNER WHATSOEVER AND SHALL BE USED ONLY FOR THE PROJECT ISSUED FOR. THIS DRAWING TO BE EXECUTED ON SITE SUBJECT TO THE APPROVAL OF COMPETENT AUTHORITY.

SANCTION DRAWINGS

ARCHITECTURAL DRAWING

FRONT (WEST) SIDE ELEVATION

SCALE: 1:100
DATE: 31/03/2023
DRAWN BY: MB/AF/C
CHECKED BY: AM/MB
DWG. NO.: RUCHI-MDD-AS-12

CONSULTANT: ARCHITECT
Eccleston, Bp - 7th Floor, Sector V,
Salt Lake, Kolkata - 700091, India
T: 033-26787979, 26788083
S: 033-26787979, 26788083
www.salientgroupindia.com

PROJECT: PROPOSED (B-6+13) STORED MERCANTILE ASSEMBLY BUILDING AT PREMISES NO. 02/01/78, PLOT NO. C/P/2, ACTION AREA I, NEW TOWN, KOLKATA - 700158

DESIGNER: JIBER PILLAI
S: 033-26787979, 26788083
T: 033-26787979, 26788083
M: 9850152888, 9115

ARCHITECT'S SIGNATURE: [Signature]

CERTIFICATE OF ARCHITECT: [Text]

ARCHITECT'S SIGNATURE: [Signature]

CERTIFICATE OF STRUCTURAL ENGINEER: [Text]

STRUCTURAL ENGINEER'S SIGNATURE: [Signature]

CERTIFICATE OF GEO-TECH ENGINEER: [Text]

GEO-TECH ENGINEER'S SIGNATURE: [Signature]